

PANEL LIGHTS



LLP 2'x 2' DROP-IN LED PANEL LIGHTING | LLP-PL-50W-4000K-DIM-REM |

BENEFITS

- Slim & simple design.
- Dimming Control.
- Reliably produces clear, bright illumination that reduces operational and maintenance costs.
- Open rated for maximum air flow.
- Junction temperature of LED light source is kept below 149°F (65°C). (Theoretically, in order for LED to get life span over 50,000 hours the junction temperature should be below 176°F (80°C))
- Heat sources like transformer and FET of the SMPS are designed with heat dissipating mechanical structure to keep the temperature difference (ΔT) between inside lead and outside temperature not more than 86°F (30°C).
- As commonly known, the air flows from cold to hot. The 2'x2' LED Panel Light maximizes this natural convection at the level of fixture design utilizing optimal mechanical structure for vertically positioned LED module.
- 50 Watts – 92% more efficient than comparable 90W (FL20Wx4 engagement) fluorescent lamps. Maintenance free operation lasts up to 16 times longer than fluorescent lighting.
- Must be installed by a licensed electrician.

FEATURES

Name	LED 2x2 Panel Lighting
Product Code	LLP-PL- 50W-4000K-DIM-REM
Equivalent Source	Up to 90W(FL20Wx4 engagement) fluorescent lamps
L70 lumen depreciation design criteria =	Panel Lighting: 50,000 hours Rating is based on open-air fixture application.
Housing	Poly Carbonate, PMMA/ Powder Coating
Installation Type	Recessed
Beam Spread	120°
Operating Temperature	-50°F~122°F (-10°C to +50°C)
IP Rating	IP20
Voltage	100VAC~277VAC (2323)/ AC100~240V (5252)
Frequency	50/60Hz (47~65Hz)
Weight	7.9 lb., 3.6Kg
Length	23.6"(600.0mm)
Height	3.6"(92.1mm)
Width	23.6"(600.0mm)
Power Factor	≥0.916
Lumens/ Watt (lm/W)	95 lm/W
Luminous Flux (lm)	4,750lm
Color Rendering Index (CRI)	CRI 80
Color Temperature	4000K (3500K, 5000K, 5700K, 6500K, RGB Optional)
Warranty	5-Year Warranty

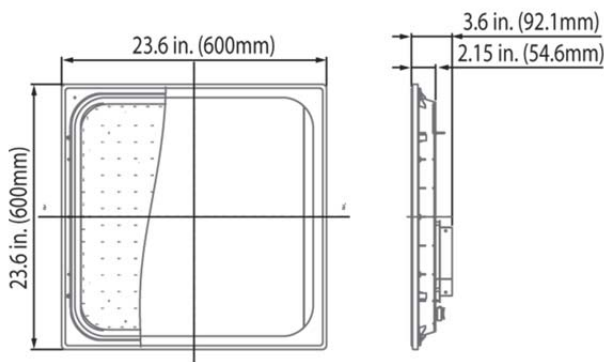

ORDERING INFORMATION \ \ LLP 2'x2' LED PANEL LIGHT SERIES

PRODUCT CODE: **LLP-PL-50W-4000K-DIM-REM**

Family	Product	Wattage	Color (CCT)		Distribution	Voltage ⁴		Base
LLP	PL	50W	4000K-NW	Neutral White	120°	100-277	Volt	Poly Carbonate, PMMA



Prepared By:	Product Code:
Project:	Date:

The LED 2'x2' SERIES has high system efficiency (actual efficiency more than 90%). LED light contains less infrared (heat) than incandescent lamps, eliminating risk of damage from a rise in temperature. Any usage interfering LED heat dissipation may cause damage to the product. LEDs also reduce concern of deterioration or discoloration from ultraviolet (UV) rays, because they have limited emissions in the UV spectrum. Other LED benefits include instant full brightness (as opposed to "warming up") and silent operation (versus the buzz of fluorescent ballasts, e.g.). Additionally, at the end of their long life cycle, LEDs begin to fade versus "burning out," which provides ample time to change out bulbs. It is important that this product must be installed by a professional electrician with the relevant standard of electrical code and the appropriate installation guide. Any modification or dismantle of this product may cause serious injury. Any usage of input power (except rating voltage) may cause serious damage.

Cautions

- Turn power off before inspection, installation, or removal.
- Risk of Electric Shock – Do not use where directly exposed to water or weather.
- For use in recessed fixtures.
- Do not open – no user serviceable parts inside.
- This device is not intended for use with emergency exit fixtures or emergency exit lights.

LED Panel Lights	Part Number
LED Panel Lighting – 2'x2' Series	
LED 2x2 Panel Lighting - 40 Watt	LLP-PL-40W-4000K-DIM-REM
LED 2x2 Panel Lighting - 45 Watt	LLP-PL-45W-4000K-DIM-REM
LED 2x2 Panel Lighting - 50 Watt	LLP-PL-50W-4000K-DIM-REM
LED 2x2 Panel Lighting - 50 Watt w/ Emergency Backup	LLP-PL-50W-4000K-DIM-REM-EL1400-90
LED 2x2 Panel Lighting - 60 Watt	LLP-PL-60W-4000K-DIM-REM

